



STAINLESS STEEL

Fabricated Economy SINKS



Item #: _____ **Qty #:** _____
Model #: _____
Project #: _____

FEATURES:

- Backsplash has tile edge for ease of installation.
- Sink bowls are 3/4" coved corner and meet NSF requirements.
- Rolled Rim Edge for additional strength.
- Sink Bowls are 14" deep for greater capacity.

CONSTRUCTION:

- All TIG welded.
- Welded areas blended to match adjacent surfaces and to a satin finish.
- Gussets welded to a die-embossed reinforced plate.

MATERIAL:

- 1 5/8" diameter stainless steel legs.
- 1" adjustable stainless steel bullet feet.
- Entire unit is 16 gauge 304 stainless steel.
- Gussets - galvanized steel.

	MODEL #	BOWL SIZE	O.A. Length	# of Drbds.
ONE COMP	FC-1-1818	18x18	23"	0
	FC-1-1818-18RorL	18x18	38 1/2"	1
	FC-1-1818-18RL	18x18	54"	1
	FC-1-1818-24RorL	18x18	45"	1
	FC-1-1818-24RL	18x18	66"	2
	FC-1-2424	24x24	29"	0
TWO COMP	FC-2-1515	15x15	35"	0
	FC-2-1818	18x18	41"	0
	FC-2-1818-18RL	18x18	72"	2
	FC-2-1818-24RL	18x18	84"	2
THREE COMP	FC-3-1515	15x15	49"	0
	FC-3-1818	18x18	59"	0
	FC-3-1515-15RL	15x15	75"	2
	FC-3-1818-18RorL	18x18	74 1/2"	1
	FC-3-1818-18RL	18x18	90"	2
	FC-3-1818-24RL	18x18	102"	2
	FC-3-1824-18RL	18x24	90"	2
	FC-3-1824-24RL	18x24	102"	2
	*FC-3-2424-24RL	24x24	120"	2

*2 Sets of Faucet Holes

ACCESSORIES	Model #	Qty
DRAINS		
FAUCETS		

<p>www.advancetabco.com</p>	<p>NEW YORK (800) 645-3166 Fax: (631) 242-6900</p>	<p>GEORGIA (800) 832-1218 Fax: (770) 775-5625</p>	<p>TEXAS (800) 527-0353 Fax: (972) 932-4795</p>	<p>NEVADA (800) 446-8684 Fax: (775) 972-1578</p>
	<p>For Assistance with Smart Modifications & Accessories Call: 1-800-498-6634 Fax: 631-586-2933 smartfab@advancetabco.com</p>			

DIMENSIONS and SPECIFICATIONS

TOL Overall: ± .500"
Interior: ± .250"

ALL DIMENSIONS ARE TYPICAL

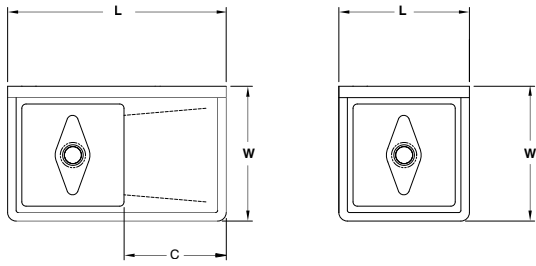

1 COMP - 1 DRBD

1 COMP

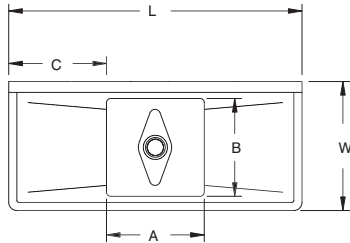

1 COMP - 2 DRBDs

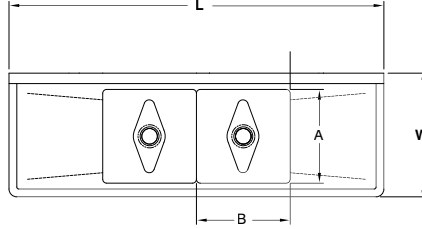

2 COMP - 2 DRBD

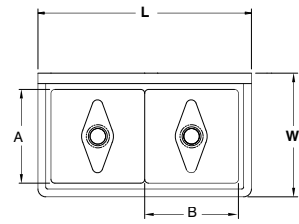

2 COMP

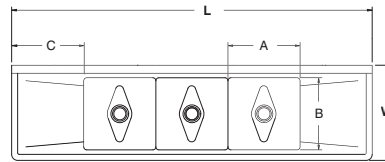

3 COMP - 2 DRBD

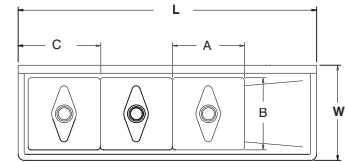

3 COMP - 1 DRBD

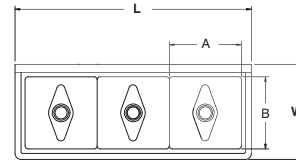

3 COMP

MECHANICAL:

- Supply is 1/2" IPS hot & cold.
- Faucet holes on 8" centers.
- Faucets are not included (**see accessories**).
- Waste drains are 1 1/2" IPS S/S basket type, located in center of sink bowl, and are included.



	MODEL #	Length L	Width W	Bowl Size A & B	Drbd. Length C	# of Drbrds.	Drbrd. Location	Wt	
ONE COMP	FC-1-1818	23"	24"	18x18	N/A	0	None	60 lbs.	
	FC-1-1818-18RorL	38 1/2"	24"		18"	1	Specify	70 lbs.	
	FC-1-1818-18RL	54"	24"		18"	1	Both	90 lbs.	
	FC-1-1818-24RorL	44 1/2"	24"		24"	1	Specify	75 lbs.	
	FC-1-1818-24RL	66"	24"		24"	2	Both	100 lbs.	
	FC-1-2424	29"	30"	24x24	N/A	0	None	90 lbs.	
TWO COMP	FC-2-1515	35"	21"	15x15	N/A	0	None	55 lbs.	
	FC-2-1818	41"	24"	18x18	N/A	0	None	83 lbs.	
	FC-2-1818-18RL	72"	24"		18"	2	Both	105 lbs.	
	FC-2-1818-24RL	84"	24"		24"	2	Both	115 lbs.	
THREE COMP	FC-3-1515	50"	21"		15x15	N/A	0	None	110 lbs.
	FC-3-1515-15RL	75"	21"	15"	2	Both	120 lbs.		
	FC-3-1818	59"	24"	18x18	N/A	0	None	120 lbs.	
	FC-3-1818-18RorL	74-1/2"	24"		18"	1	Specify	130 lbs.	
	FC-3-1818-18RL	90"	24"		18"	2	Both	140 lbs.	
	FC-3-1818-24RL	102"	24"		24"	2	Both	150 lbs.	
	FC-3-1824-18RL	90"	30"		18x24	18"	2	Both	225 lbs.
	FC-3-1824-24RL	102"	30"			24"	2	Both	250 lbs.
*FC-3-2424-24RL	120"	30"	24x24			24"	2	Both	350 lbs.

*2 Sets of Faucet Holes

