

Item #: \_\_\_\_\_ Qty #: \_\_\_\_\_  
 Model #: \_\_\_\_\_  
 Project #: \_\_\_\_\_



Stainless Steel Bullet Feet  
standard on SLAG &  
FLAG Series



Plastic Bullet Feet  
standard on ELAG,  
FLAG & KLAG Series



SLAG Series - Flat Top



ELAG Series - Flat Top



KLAG - 5" Backsplash



FLAG & SFLAG Series - 1 1/2" Backsplash

		FLAT TOP			1 1/2" SPLASH			5" SPLASH		
WIDTH	LENGTH	ELAG	WT.	SLAG	WT.	FLAG	SFLAG	WT.	KLAG	WT.
24"	30"	ELAG-240	49 lbs.	SLAG-240	49 lbs.	FLAG-240	SFLAG-240	49 lbs.	-	-
	24"	ELAG-242	31 lbs.	SLAG-242	31 lbs.	FLAG-242	SFLAG-242	31 lbs.	-	-
	36"	ELAG-243	64 lbs.	SLAG-243	64 lbs.	FLAG-243	SFLAG-243	64 lbs.	KLAG-243	64 lbs.
	48"	ELAG-244	79 lbs.	SLAG-244	79 lbs.	FLAG-244	SFLAG-244	79 lbs.	KLAG-244	79 lbs.
	60"	ELAG-245	92 lbs.	SLAG-245	92 lbs.	FLAG-245	SFLAG-245	92 lbs.	KLAG-245	92 lbs.
	72"	ELAG-246	109 lbs.	SLAG-246	109 lbs.	FLAG-246	SFLAG-246	109 lbs.	KLAG-246	109 lbs.
	96"	ELAG-248	145 lbs.	SLAG-248	145 lbs.	FLAG-248	SFLAG-248	145 lbs.	KLAG-248	145 lbs.
30"	30"	ELAG-300	65 lbs.	SLAG-300	65 lbs.	FLAG-300	SFLAG-300	65 lbs.	KLAG-300	65 lbs.
	36"	ELAG-303	72 lbs.	SLAG-303	72 lbs.	FLAG-303	SFLAG-303	72 lbs.	KLAG-303	72 lbs.
	48"	ELAG-304	89 lbs.	SLAG-304	89 lbs.	FLAG-304	SFLAG-304	89 lbs.	KLAG-304	89 lbs.
	60"	ELAG-305	107 lbs.	SLAG-305	107 lbs.	FLAG-305	SFLAG-305	107 lbs.	KLAG-305	107 lbs.
	72"	ELAG-306	125 lbs.	SLAG-306	125 lbs.	FLAG-306	SFLAG-306	125 lbs.	KLAG-306	125 lbs.
	96"	ELAG-308	166 lbs.	SLAG-308	166 lbs.	FLAG-308	SFLAG-308	166 lbs.	KLAG-308	166 lbs.

**FEATURES:**

**ELAG & SLAG** Top is furnished with 1 5/8" square bend on sides and 1 5/8" sanitary rolled rim on front and rear and square sides.

**FLAG & SFLAG** Top is furnished with 1 5/8" square bend on sides and 1 5/8" sanitary rolled rim on front and square sides, and 1 1/2" backsplash on rear.

**KLAG** Top is furnished with 1 5/8" square bend on sides and 1 5/8" sanitary rolled rim on front and square sides, and 5" backsplash on rear.

Two hat-channels stud welded under tabletop to reinforce and maintain a level work surface.

Aluminum die cast "leg-to-shelf" clamp secures shelf to leg eliminating unsightly nuts and bolts. Underself is fully adjustable.

**CONSTRUCTION:**

All TIG welded. Exposed weld areas polished to match adjacent surface. Top is sound deadened.

Stud welded hat section reinforces and maintains a level working surface. Gussets welded to support hat channels.

**MATERIAL:**

**ELAG, FLAG & KLAG SERIES:**

**TOP:** Heavy gauge stainless steel type "430" series.

**SHELF:** 18 gauge galvanized steel.

**LEGS:** 1 5/8" diameter tubular galvanized steel. Galvanized steel gussets. 1" adjustable plastic bullet feet.

**SLAG & SFLAG SERIES:**

**TOP:** Heavy gauge stainless steel type "430" series.

**SHELF:** 18 gauge stainless steel.

**LEGS:** 1 5/8" diameter tubular stainless steel. Stainless steel gussets. 1" adjustable stainless steel bullet feet.

# DETAILS and SPECIFICATIONS

TOL  $\pm$  .500"

ALL DIMENSIONS ARE TYPICAL

## SLAG & ELAG SERIES - Flat Top

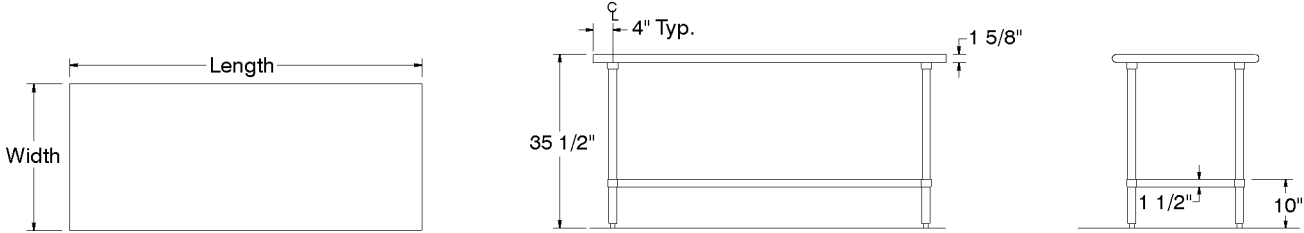

## SFLAG SERIES & FLAG SERIES - 1 1/2" Backsplash

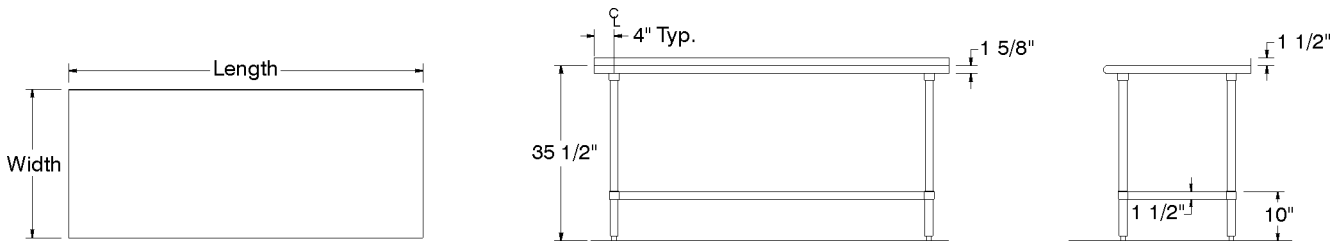

## KLAG SERIES - 5" Backsplash

